

LADO MOTOR/MOTOR SIDE/CÔTÉ DE MOTEUR | LADO BOMBA/PUMP SIDE/CÔTÉ DE POMPE

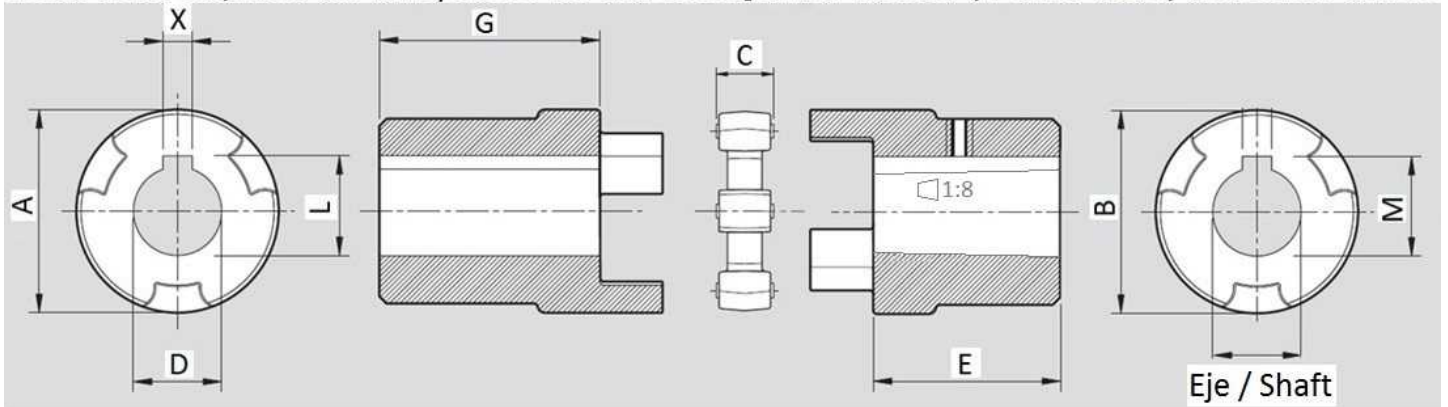

Medida eje / Shaft size  
 F1: 8 - 10 mm  
 F2: 14.6 - 17 mm  
 F3: 19 - 22 mm  
 F3.5: 21.4 - 24.6 mm

Part nº	Size	Details	Spiders	Motor side	Pump side	ØA	ØB	ØD	C	E	G	L	M	X
ND3	11 mm	CILINDRICO	5158045	0,16/0,25 CV/HP	F 1	45	45	14	16	15	29	16	13,8	5
ND1A	14 mm	CILINDRICO	5158045	0,35/0,5 CV/HP	F 1	45	45	14	16	15	29	16	11	5
ND2	14 mm	CONICO 1:8	5158045	0,33/0,5 CV/HP	F 1	45	45	14	16	15	29	16	11	5
ND5	19 mm	CONICO 1:8	5158045	0,75/1 CV/HP	F 1	45	45	19	16	15	50	22	11	6
ND8	24 mm	CONICO 1:8	5158045	1,5/2 CV/HP	F 1	45	45	24	16	15	50	27	11	8
ND11	28 mm	Cónico/Conical 1:8	5158055	3/5,5 CV/HP	F 1	55	55	28	18	20	60	31	11	8
ND7	19 mm	CONICO 1:8	5158045	0,75/1 CV/HP	F 2	45	45	19	16	15	48	21	18,3	6
ND10	24 mm	CONICO 1:8	5158045	1,5/2 CV/HP	F 2	45	45	24	16	15	48	27	18,3	8
ND13	28 mm	CONICO 1:8	5158055	3/5,5 CV/HP	F 2	55	55	28	18	20	58	31	18,3	8
ND16	38 mm	CONICO 1:8	5158074	7,5/12,5 CV/HP	F 2	74	74	38	20	25	80	41	18,3	10
ND43A	42 mm	CONICO 1:8	5158074	15/20 CV/HP	F 2	104	104	42	24	30	110	45	18,3	12
ND15	28 mm	CONICO 1:8	5158074	3/5,5 CV/HP	F 3	55	55	28	18	20	60	31	24,8	8
ND17	38 mm	CONICO 1:8	5158074	7,5/12,5 CV/HP	F 3	74	74	38	20	30	80	41	24,8	10
ND43C	42 mm	CONICO 1:8	5158104	15/20 CV/HP	F 3	104	104	42	24	30	110	45	24,8	12
ND18C	38 mm	CONICO 1:8	5158104	7,5/12,5 CV/HP	F 3.5	74	74	38	20	25	80	41	28,3	10
ND21A	42 mm	CONICO 1:8	5158104	15/20 CV/HP	F 3.5	104	104	42	24	30	110	45	28,3	12
ND25A	48 mm	CONICO 1:8	5158104	25/30 CV/HP	F 3.5	104	104	48	24	30	110	51	28,3	14
ND41A	55 mm	CONICO 1:8	5158104	31/40 CV/HP	F 3.5	104	104	55	24	30	110	59	28,3	16
ND44C	48 mm	CONICO 1:8	5158104	25/30 CV/HP	F 3	104	104	48	24	30	110	51	24,8	14